

CARBIDE DRILL BITS *For Concrete and Masonry*



CARBIDE DRILL BITS

Our carbide-tipped drill bits are premium quality, professional-grade tools manufactured in Germany to the highest industry standards. They are designed to meet precise tolerance requirements and incorporate proprietary features that enhance durability, drilling speed and usability. Regular and quad head bit tip configurations are available. Shank styles include SDS-Plus®, SDS-Max, Spline, and Straight.

FEATURES AND BENEFITS:

- Uniformly-brazed carbide inserts result in longer bit life
- Most bits contain a centering tip that facilitates easy spot drilling
- Chromium-nickel-molybdenum steel alloy body ensures hammering quality and extended service life
- Heat-treatment procedures and shot peened finish increase surface hardness, drilling speed, reduces drill bit wear and improves resistance to bending forces
- Drill bits conform to ANSI Standard B212.15

ADDITIONAL ATTRIBUTES FOR SDS-MAX, SPLINE AND SELECT SDS-PLUS BITS:

- Chisel-shaped drill bit head penetrates the material and directs concrete dust into the multi-flute spiral
- Patented, high-volume, multi-flute spiral quickly channels concrete dust from the hole to improve drilling speed
- Proprietary flute geometry reduces vibration and optimizes impact energy transfers from the rotary hammer into the drill bit tip which enhances drilling speed and durability and reduces noise, stress and vibration on the operator

QUAD HEAD FEATURE:

(Available in SDS-PLUS, SDS-MAX and Spline Shank)

All the features of single cutter bits plus Quad Head dual cutter design to improve durability and drilling speed. The high volume, double helix of Quad Head bit is produced with the patented, high-performance, reinforced core flute to maximize energy transfer.

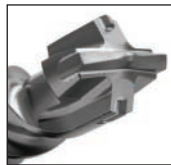

Quad Head^{4x}

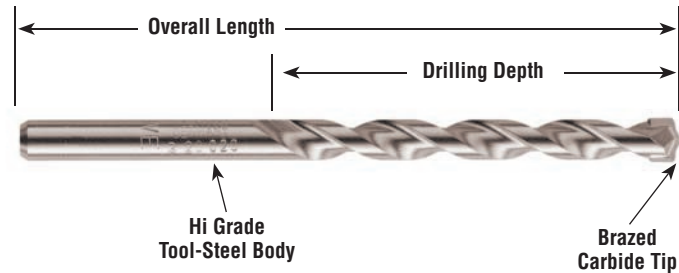

Simpson Strong-Tie® Drill Bits come in various shank styles to fit virtually any drill or rotohammer.



Drill Bit Tool Selection Guide

SDS-PLUS

Fits all current and older SDS PLUS rotohammers from AEG, Black & Decker, Bosch, DeWalt, Hitachi, Hilti, Kango, Makita, Metabo, Milwaukee, Porter Cable, Ramset, Red Head, Ryobi, Skil

SDS-MAX

Fits all current and older SDS PLUS rotohammers from Black & Decker, Bosch, DeWalt, Hitachi, Hilti, Kango, Makita, Metabo, Milwaukee

Spline

Fits all current and older Spline rotohammers from AEG, Black & Decker, Bosch, DeWalt, Hitachi, Kango, Makita, Metabo, Milwaukee, Ramset, Red Head, Ryobi

The following are registered trademarks: AEG® – AEG Power Tool Corp. Bosch® – Robert Bosch Power Tool Corp. SDS Plus® and SDS Max® are registered

trademarks of Robert Bosch Power Tool Corp. B&D® – Black and Decker US, Inc. Hilti® – Hilti of America, Inc. Hitachi® – Hitachi Power Tools USA, Ltd.

Kango® – Kango Wolf Power Tools, Inc. Makita® – Makita USA, Inc. Metabo® – Metabo Corp. Milwaukee® – Milwaukee Electric Tool Corp.

Porter Cable® – Porter Cable Corporation Ramset® – Illinois Tool Works Red Head® – Illinois Tool Works Ryobi® – Ryobi America Corporation